

ALEXANDER LINN HOSPITAL BUILDING FUND

12 NEWTON AVENUE • P.O. BOX 471

SUSSEX, NEW JERSEY

TELEPHONE 875-5171

Board of Trustees

Emanuel A. Honig, *President*

Donald Bliss
Carroll Dailey
Laurens Hardin, Sr.
Theodore F. Holbert

Mrs. Adrian Hommel
Jack Kurlander
Clifton E. Lawrence
Stanley Myslinski

Roy G. Rohel
Irwin H. Treiser, O. D.
John L. Voellmicke
Wallace Richard Wirths

Chairman of the Fund

Clifton E. Lawrence

Memorial Gifts Committee

Roy G. Rohel, *Chairman*

Carroll Dailey
Laurens Hardin, Sr.
Theodore F. Holbert
Emanuel A. Honig

Clifton E. Lawrence
Kenneth E. Meredith
Andrew W. Roy

Nelson Struck
Irvin H. Treiser, O. D.
Mrs. Leslie R. Vermes
M. Lawrence Wilson

Corporation Gifts Committee

Morris Busacco, *Chairman*

E. H. Cooper
Theodore F. Holbert
Emanuel A. Honig

John Kurlander

Kenneth E. Meredith
H. Dale Shay
Robert Smith

Doctors' Steering Committee

H. Vinton Coes, M. D. *Chairman*

Leslie R. Vermes, M. D.

Ewald H. Bergman, M. D.

Hospital Employee Campaign

Jo Ann Williams, *Chairman*

Mrs. Cora Adams
Mrs. William Brindle
Mrs. Gilbert Coates

John Hardick
Mrs. Harrison Knox
Miss Marion Munkacsy

Dean Patterson
James A. Rhinesmith
Mrs. Jane Vidas

General Public Campaign

Walter J. McCarroll, *Chairman*

Regional Chairmen
Robert J. Bell
Lester A. Drew

Paul Grau

Regional Chairmen
William J. Rutherford, Jr.
George F. Zeigler

ALEXANDER LINN HOSPITAL - SUSSEX, NEW JERSEY

Kenneth E. Meredith, *Administrator*

a
GREATER
hospital

for a
growing
community

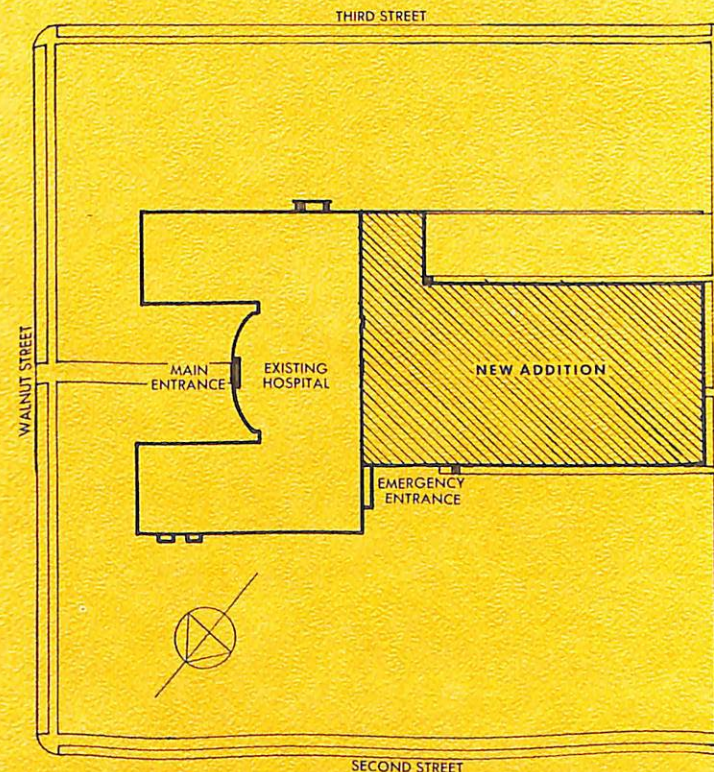

ALEXANDER
LINN
HOSPITAL

must
EXPAND
now

QUESTIONS AND ANSWERS

What is the estimated total cost? How much must the public provide? When will the first building phase of the master plan of expansion begin?

The total estimated cost of the master plan is \$2,700,000. The first building phase is estimated at \$1,800,000. The public is being asked to contribute a minimum of \$300,000.

Why is a new addition needed?

To provide additional beds and more space for the over-taxed supporting departments, so that Alexander Linn Hospital can more effectively fulfill its role as a protector of community health.

Are contributions deductible on tax returns?

Yes. Payments on subscriptions each year are deductible on Federal income tax returns.

Why should I help build the hospital as well as pay for my bed as a patient?

A patient even when his bill is marked "Paid in Full" has paid only for the services he has received. He has paid nothing toward building or equipping the hospital. The cost of construction has been contributed over the years by the public throughout the hospital's service area. Without your help there may not be an available bed for you.

Who should subscribe?

Everyone in the many towns served by Alexander Linn Hospital. The provision of hospital facilities you and your neighbors need and must have is a community responsibility which, when shared by all, can easily be met. A subscription to the building fund is not a 'gift'; it is an investment in your own family's future health and well-being.

How much should I subscribe?

As much as you can see your way clear to pledge over three years' income. The \$300,000 building fund is the largest fund-raising program ever undertaken here. It will benefit all of us. It calls for subscriptions many times as large as the amounts we usually give to annual appeals. The easiest way to make this investment is by a six-payment *pledge*, not just with cash from your pocket. See how a small amount set aside each day makes a substantial contribution.

This Little Each Day:	Means This Much Each Six Months:	Completing A Pledge Of:
\$2.46	\$400	\$2400
1.23	200	1200
.61	100	600
.31	50	300
.17	30	180
.13	25	150
.11	20	120

How can I subscribe?

Soon a volunteer will call on you to explain how the six-payment plan will enable you to make a subscription in keeping with the importance of the project. This is an opportunity for all of us to get together and accomplish something for our own benefit that none of us could do alone.

ALEXANDER LINN HOSPITAL BUILDING FUND

12 NEWTON AVENUE • P.O. BOX 471

SUSSEX, NEW JERSEY

TELEPHONE 875-5171

Board of Trustees

Emanuel A. Honig, *President*

Donald Bliss
Carroll Dailey
Laurens Hardin, Sr.
Theodore F. Holbert

Mrs. Adrian Hommell
Jack Kurlander
Clifton E. Lawrence
Stanley Myslinski

Roy G. Rohel
Irwin H. Treiser, O. D.
John L. Voellmicke
Wallace Richard Wirths

Chairman of the Fund

Clifton E. Lawrence

Memorial Gifts Committee

Roy G. Rohel, *Chairman*

Carroll Dailey
Laurens Hardin, Sr.
Theodore F. Holbert
Emanuel A. Honig

Clifton E. Lawrence
Kenneth E. Meredith
Andrew W. Roy

Nelson Struck
Irvin H. Treiser, O. D.
Mrs. Leslie R. Vermes
M. Lawrence Wilson

Corporation Gifts Committee

Morris Busacco, *Chairman*

E. H. Cooper
Theodore F. Holbert
Emanuel A. Honig

John Kurlander

Kenneth E. Meredith
H. Dale Shay
Robert Smith

Doctors' Steering Committee

H. Vinton Coes, M. D., *Chairman*

Leslie R. Vermes, M. D.

Ewald H. Bergman, M. D.

Hospital Employee Campaign

Jo Ann Williams, *Chairman*

Mrs. Cora Adams
Mrs. William Brindle
Mrs. Gilbert Coates

John Hardick
Mrs. Harrison Knox
Miss Marion Munkacsy

Dean Patterson
James A. Rhinesmith
Mrs. Jane Vidas

General Public Campaign

Walter J. McCarroll, *Chairman*

Regional Chairmen

Robert J. Bell
Lester A. Drew

Paul Grau

Regional Chairmen
William J. Rutherford, Jr.
George F. Zeigler

ALEXANDER LINN HOSPITAL SUSSEX, NEW JERSEY

Kenneth E. Meredith, *Administrator*

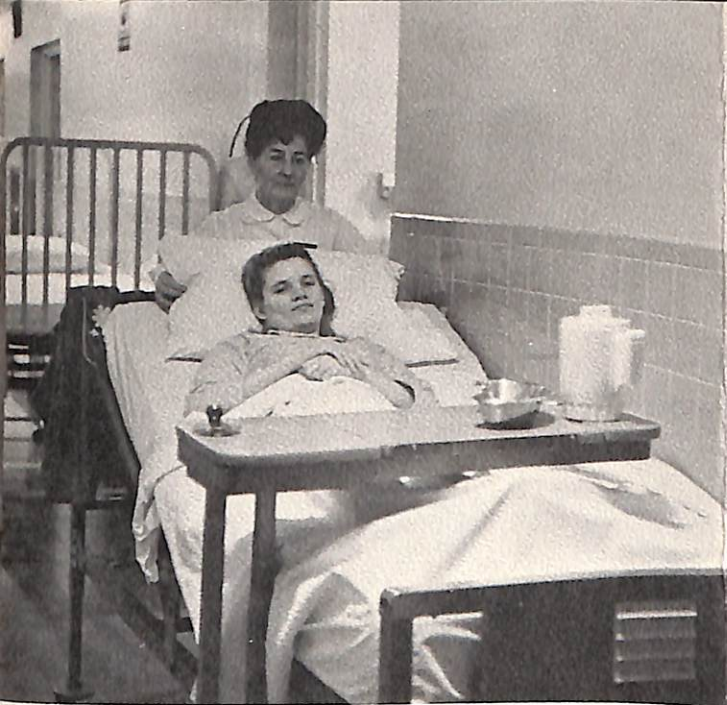

OVERCROWDING SUCH AS THIS . . . WILL BE ELIMINATED

ACTION NOW BEING TAKEN

- The master plan calls for the construction of a basement, ground-floor and two-story addition, which will increase the capacity of the hospital to 129 beds.
- The first phase of this master plan, to be undertaken at this time, will provide space for a total of 100 beds, an increase of 57 over the present number.
- A new and much larger laboratory to process many patient tests faster and more efficiently.
- A new intensive-care unit for patients requiring round-the-clock special attention and constant observation.
- A new and larger outpatient and emergency department conveniently situated near both the x-ray and laboratory sections.
- A new postoperative recovery room for surgical patients during the crucial period immediately following an operation.
- An expanded radiology department to give patients the full benefit of today's advanced diagnostic procedures.
- An expanded physical therapy department, a modernized dietetic department, an expanded kitchen, a coffee shop, new mechanical services, locker rooms for staff and personnel, and added storage space.

When the master-plan of expansion is completed, we shall have a complete and modern hospital that during the coming years will ensure for our people the type of service they want and must have.

A NEW LEASE ON YOUR HEALTH

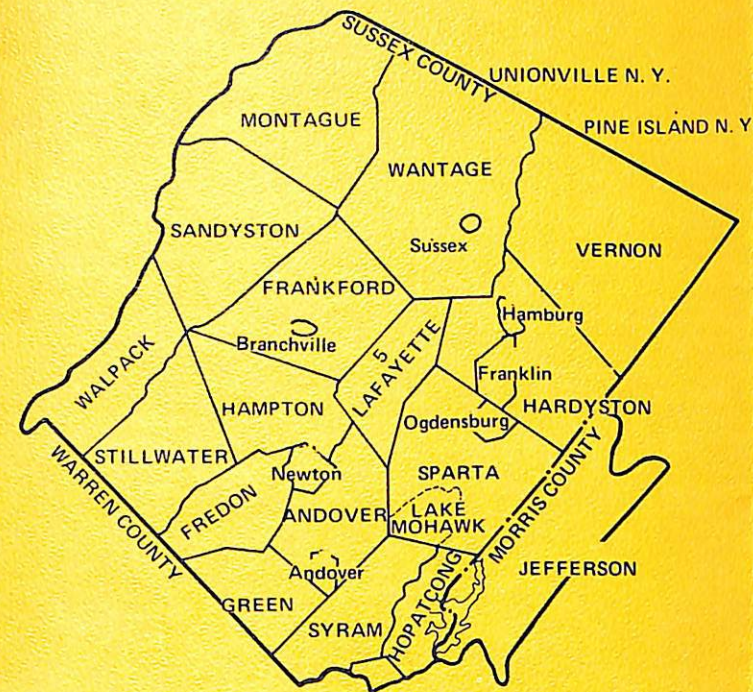

WHERE PATIENTS COME FROM AND WHAT THEY SAY

Each year many former patients return filled-in questionnaires giving their impressions of the service they received during their stay in the Alexander Linn Hospital. Here are a few typical ones:

I received very good care with a capable staff to look after me.

I could not have had better care anywhere. All the nurses and other help were very kind to me and I want to thank you all.

I was a patient for three weeks and during that time everyone was wonderful. The aides were just tops. Everyone was more than helpful and never a complaint was heard. They really work hard, too.

All I can say is that the care was excellent and I really appreciated it very much!

Thanks to a courteous and efficient staff, my first stay in a hospital was a pleasant experience for me.

I sincerely appreciate the efficient care at my time of emergency. I thank everyone who attended me and am only sorry that I do not know their names as I would personally like to thank each one.





The Hospital in 1920

Yes, Alexander Linn Hospital must expand. Now in its fifty-first year of service to thousands in the Sussex County area, the hospital has reached a decisive point—a point of no return. The Board of Trustees and the medical staff have recommended a major expansion.

Alexander Linn Hospital urgently needs more beds. Bed occupancy in the present medical-surgical nursing units has exceeded 100 percent for the last three years, rising to 119 percent during a single year, *the highest occupancy rate in the state of New Jersey.*

Largely responsible for this is the tremendous population explosion in Sussex County. In an effort to cope with increasing demand, “temporary” beds have been placed in all solaria, and even offices have been pressed into service as rooms for patients. Thus, with its facilities now being used beyond capacity, and with the necessity of providing for a steadily growing population, the hospital, unless it is enlarged now, will not be able to cope with the situation.

To enable the hospital to maintain its role as an effective guardian of community health and to prepare economically for future growth, a basement, ground-floor, and two-story addition to the rear of the present hospital will be built. In addition, there will be extensive reconstruction in the existing building.

The estimated cost of the master plan of expansion is \$2,700,000. A minimum of \$300,000 is being sought by public subscription. We will seek contracts for construction of the first building phase when this goal has been reached, and the board is satisfied with the financial arrangements.

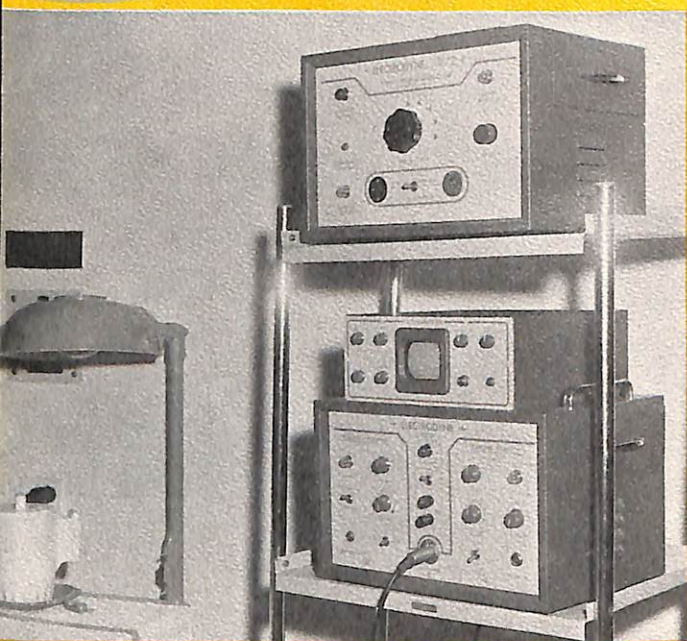

Shown above is a cardiac monitoring unit typical of modern equipment to be used in the new intensive-care unit planned for the Alexander Linn Hospital. The equipment maintains a constant vigil on the patients' heart rate and automatically warns the attending nurse of any abnormal change.



OVERCROWDING SUCH AS THIS . . . WILL BE ELIMINATED

ACTION NOW BEING TAKEN

- The master plan calls for the construction of a basement, ground-floor and two-story addition, which will increase the capacity of the hospital to 129 beds.
- The first phase of this master plan, to be undertaken at this time, will provide space for a total of 100 beds, an increase of 57 over the present number.
- A new and much larger laboratory to process many patient tests faster and more efficiently.
- A new intensive-care unit for patients requiring round-the-clock special attention and constant observation.
- A new and larger outpatient and emergency department conveniently situated near both the x-ray and laboratory sections.
- A new postoperative recovery room for surgical patients during the crucial period immediately following an operation.
- An expanded radiology department to give patients the full benefit of today's advanced diagnostic procedures.
- An expanded physical therapy department, a modernized dietetic department, an expanded kitchen, a coffee shop, new mechanical services, locker rooms for staff and personnel, and added storage space.

When the master-plan of expansion is completed, we shall have a complete and modern hospital that during the coming years will ensure for our people the type of service they want and must have.

A NEW LEASE ON YOUR HEALTH